

FOR SALE/LEASE

**11,370 SF
+ 6,000 SF YARD**



**1177, 1185, 1193, 8800 VENTURE AVE SE
CALGARY, AB**

Julie Stefan, Associate
403-804-1399 | jstefan@royallepagecommercial.com

Royal LePage Solutions, Brokerage
205, 264 Midpark Way SE, Calgary, AB
Independently Owned & Operated

John Hamilton, Associate
403-815-9041 | hamilton.calgary49@gmail.com

CMS Real Estate Ltd, Brokerage
136 - 17 Avenue NE, Calgary, AB
Independently Owned & Operated

PROPERTY OVERVIEW

FOR SALE: \$2,797,020 (\$246/SF)

FOR LEASE: \$14.00/SF (ESCALATING)

Property Overview

■ Location:	Shepard Industrial Park	■ Op Costs:	\$7.00/SF
■ Total Area:	11,370 SF	■ Taxes:	\$45,160.98 (2024)
■ Main Level:	8,339 SF	■ Power:	200 Amp x 3 (TBV)
■ Mezzanine Office:	3,031 SF	■ Zoning:	DC-56
■ Ceiling Height:	22" clear	■ Possession:	January 1, 2025
■ Loading:	3 - 16' x 16' DI door	■ Year Built:	2008
■ Lease Rate:	\$14.00/SF (Escalating)		

Property Features

- Includes 6,000 SF fenced yard
- End unit with gated yard for additional storage
- Radiant tube heaters in shop bays with makeup air system
- Excellent access to Glenmore Trail and Stoney Trail with direct access to 84th Street

[Virtual Tour](#)

PROPERTY PHOTOS



PROPERTY PHOTOS



FLOOR PLANS



SITE PLANS

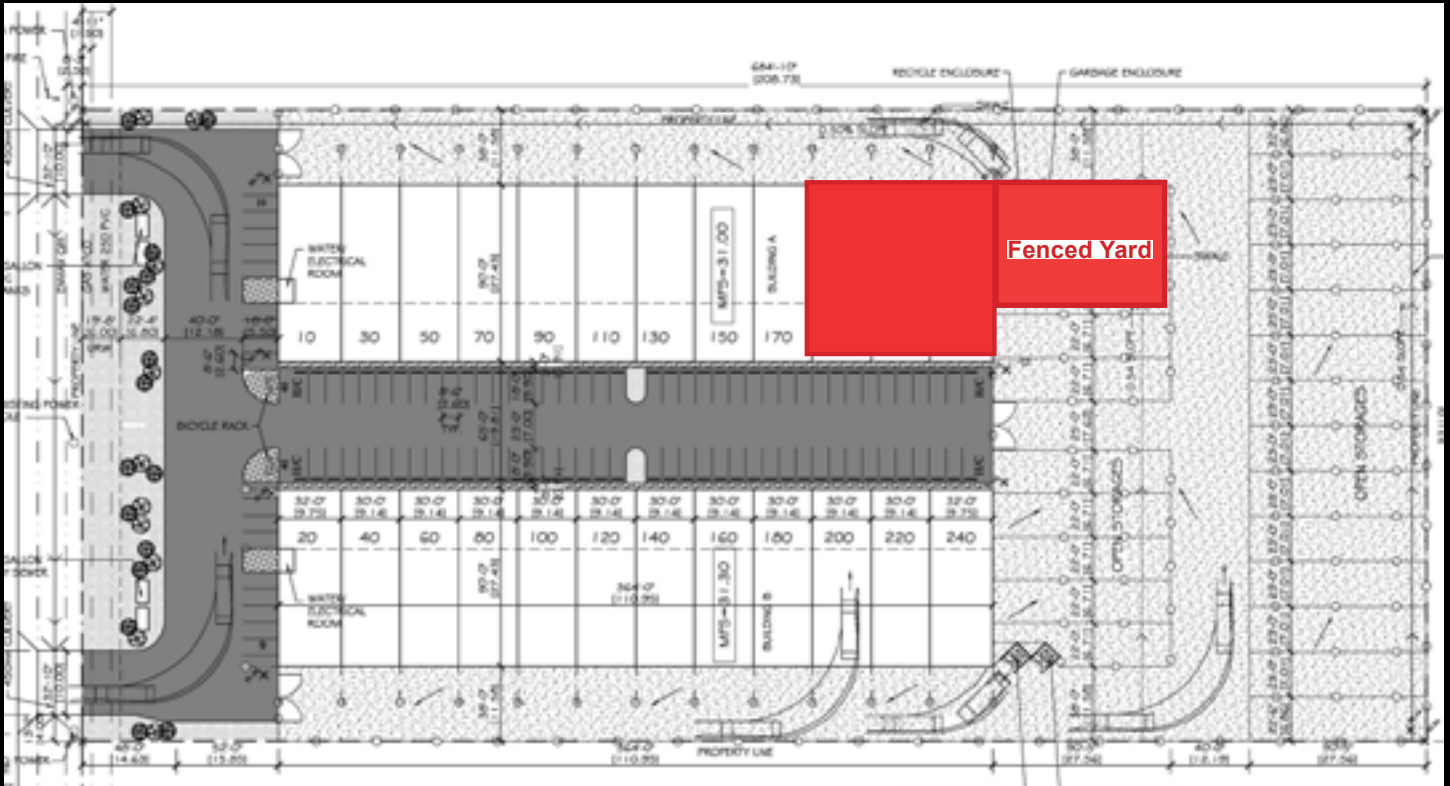

Royal LePage® is a registered trademark of Royal Bank of Canada and is used under licence by Residential Income Fund L.P., Bridgemaq Real Estate Services Inc. and Bridgemaq Real Estate Services Manager Limited. All offices are independently owned and operated, except those marked as indicated at rlp.ca/disclaimer. Not intended to solicit currently listed properties or buyers under contract. The above information is from sources believed reliable, however, no responsibility is assumed for the accuracy of this information ©2024 Bridgemaq Real Estate Services Manager Limited. All rights reserved.