

9420 Endeavor Drive SE



For SALE or LEASE

Property Features

Size: 16,613 sq.ft.
Warehouse: 13,883 sq.ft.
Main Floor Office: 1,365 sq.ft.
Second Floor Office: 1,365 sq.ft.
Yard: 0.79 Acres of Privated Fenced Yard Storage
Loading: 5 Drive-Through Doors (16' x 16')
2 Drive-In Doors (16' x 16')
Power: 400 Amp
Ceiling: 22' clear
Features: 12,000 CFM Make Up Air Unit
CO2/NO2 Detectors & Ventilation System
2 Mechanical Pits
Sump & Drain System
In Floor Heating
5 Ton Crane

Asking Rate: Market
Op Costs: TBV
Asking Price: \$3,849,000
Taxes: \$39,419 (2019)
Condo Fees: TBV



CMS Real Estate Ltd.

#200, 136- 17 Ave NE Calgary, AB T2E 1L6
403-291-0425 www.cmsrealestateltd.com



Gerry Macdonald

Broker, CCIM

403-291-0425

gm@cmsrealestateltd.com

Gerry Macdonald Jr.

Associate Broker

403-219-0161

gmjr@cmsrealestateltd.com

John Hamilton

Associate

403-815-9041

hamilton.jw@hotmail.com

Jessica Macdonald

Associate

403-219-0155

jessica@cmsrealestateltd.com

"The information contained herein is believed to be true but does not form part of any future contract. The property is subject to sale, withdrawal or price change without notice."

The information contained herein is based upon the information furnished by the principal sources, which we deem reliable - for which we cannot assume responsibility, but which we believe to be correct.

9420 Endeavor Drive SE

Site Plan

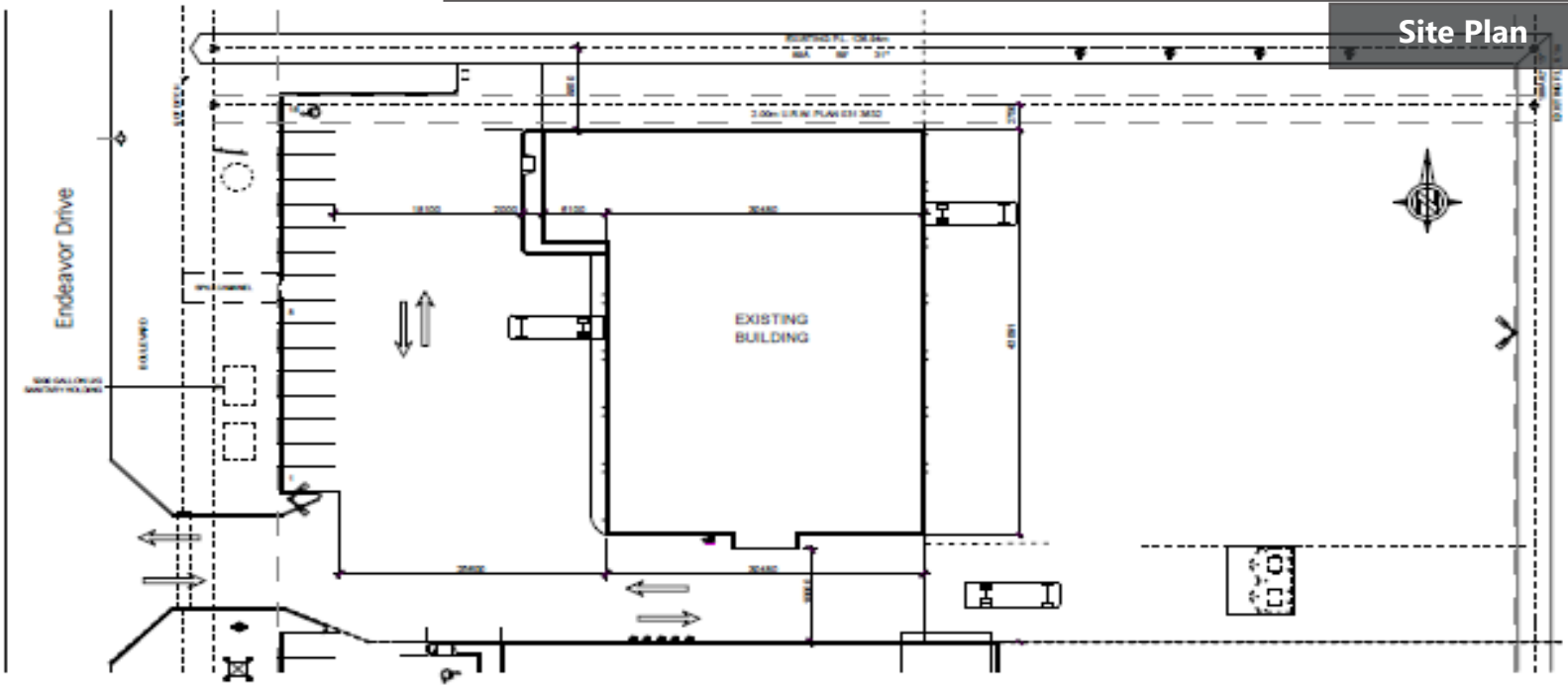

Floor Plan

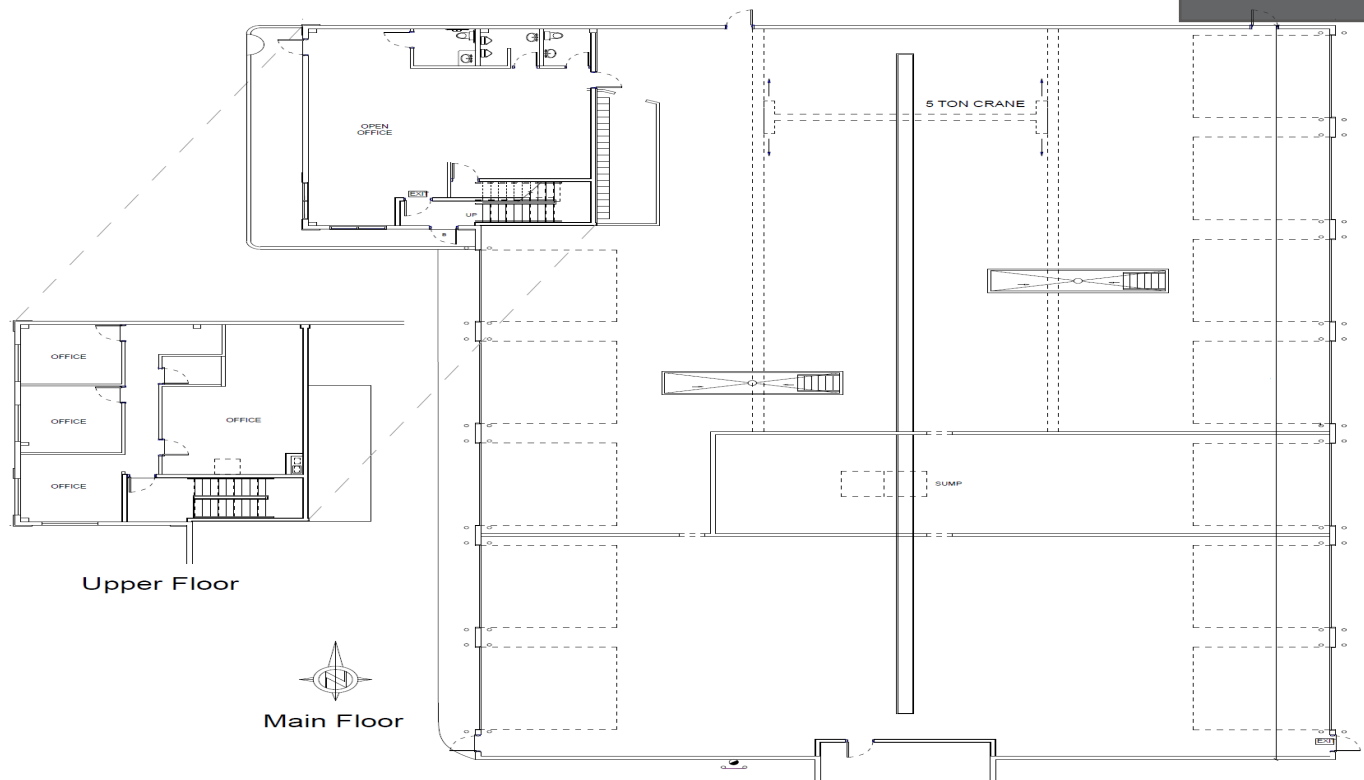

CMS Real Estate Ltd.

#200, 136- 17 Ave NE Calgary, AB T2E 1L6
403-291-0425 www.cmsrealestateltd.com



Gerry Macdonald

Broker, CCIM

403-291-0425

gm@cmsrealestateltd.com

Gerry Macdonald Jr.

Associate Broker

403-219-0161

gmjr@cmsrealestateltd.com

John Hamilton

Associate

403-815-9041

hamilton.jw@hotmail.com

Jessica Macdonald

Associate

403-219-0155

jessica@cmsrealestateltd.com

"The information contained herein is believed to be true but does not form part of any future contract. The property is subject to sale, withdrawal or price change without notice."

The information contained herein is based upon the information furnished by the principal sources, which we deem reliable - for which we cannot assume responsibility, but which we believe to be correct.